

Hinge door

Installation instructions
R-QP-F8080/F9090/F100100

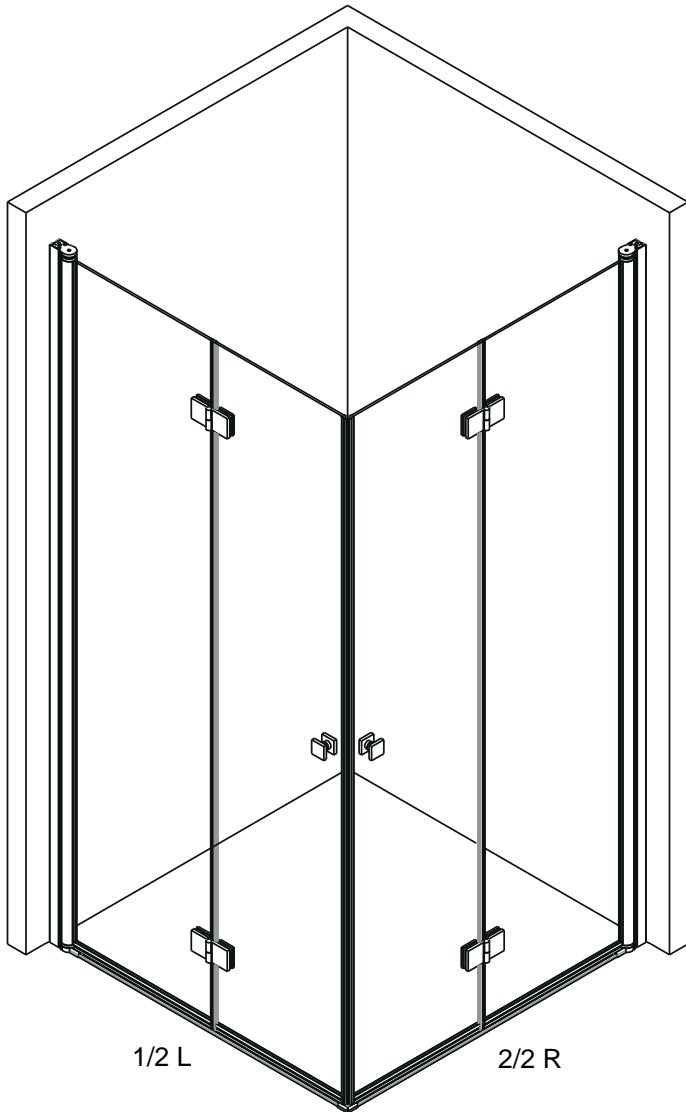

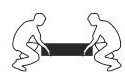

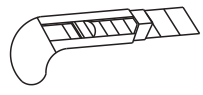
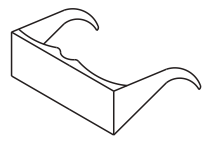
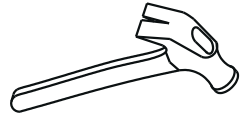
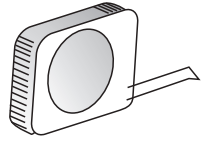
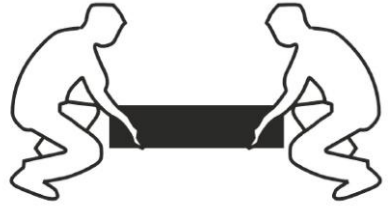
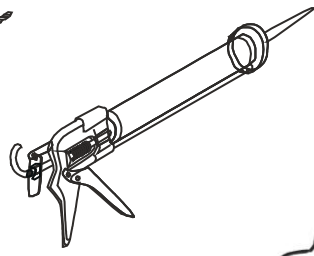
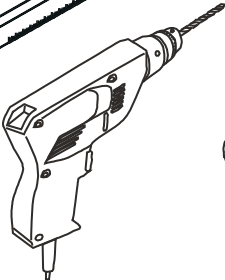
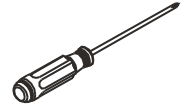
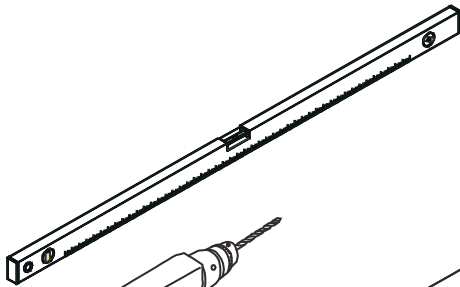
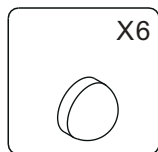
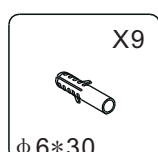
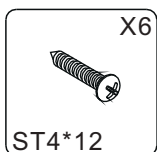
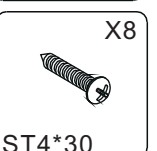
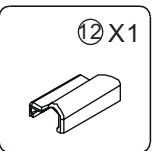
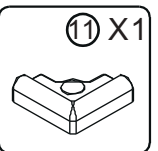
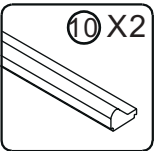
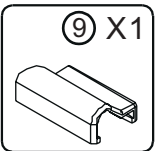
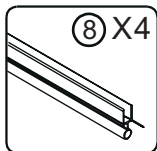
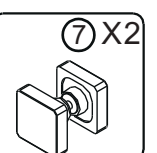
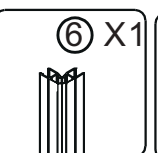
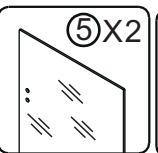
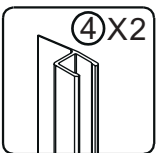
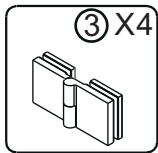
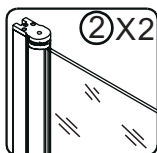
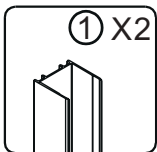
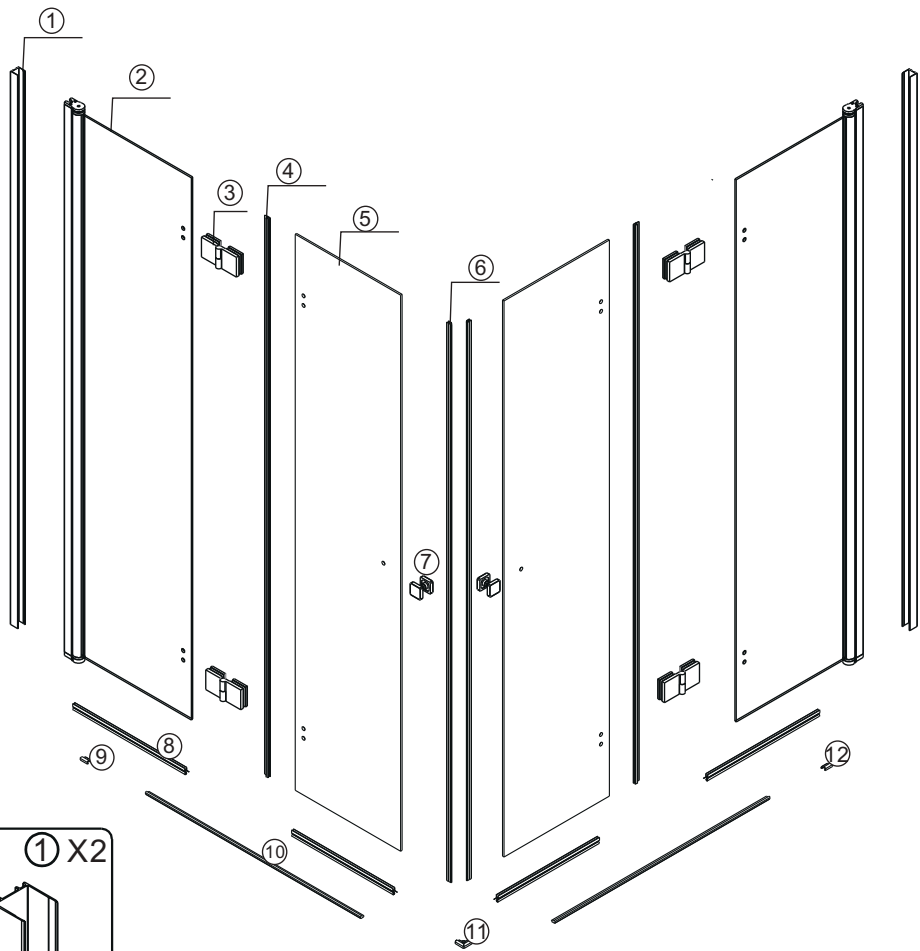

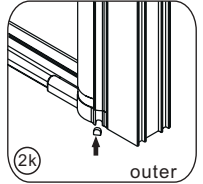
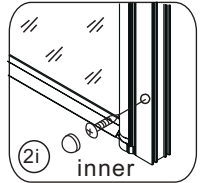
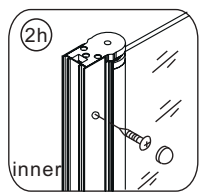
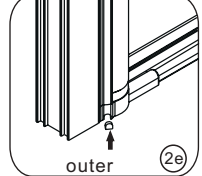
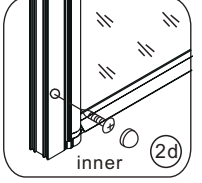
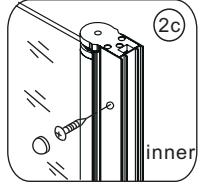
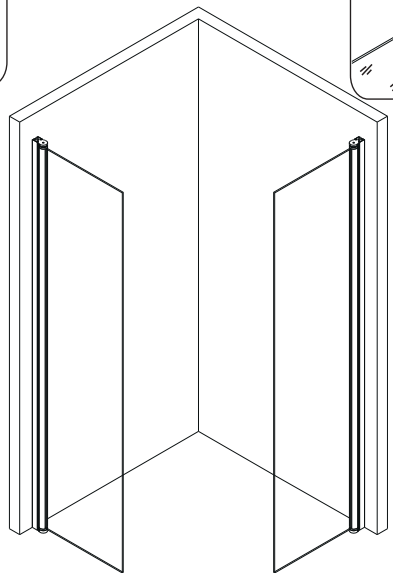
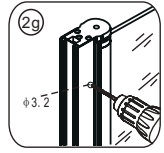
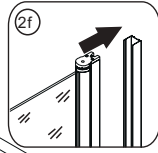
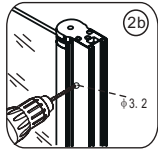
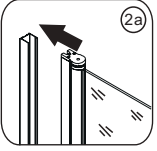
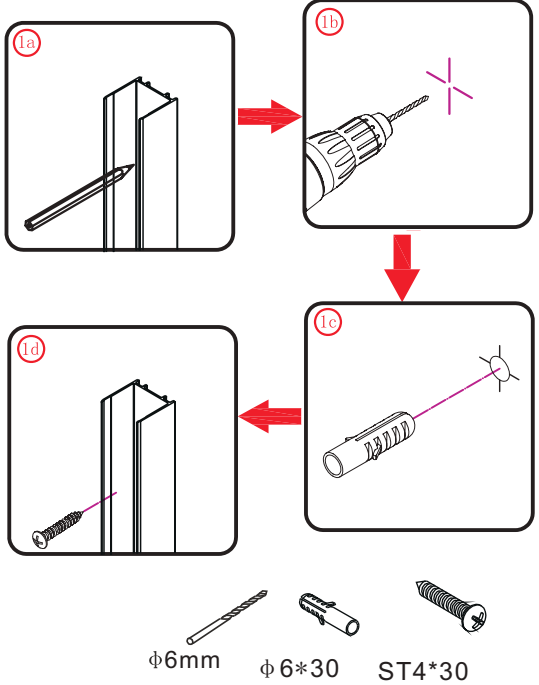
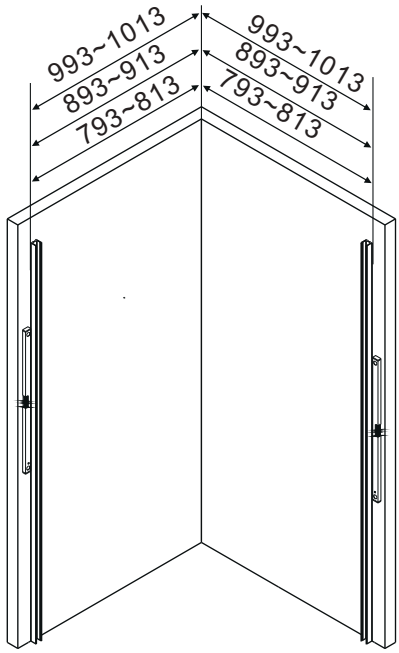

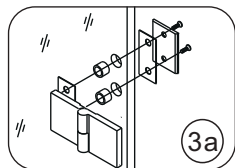

3a

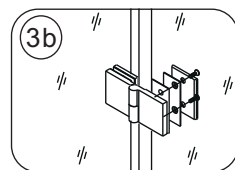

3b

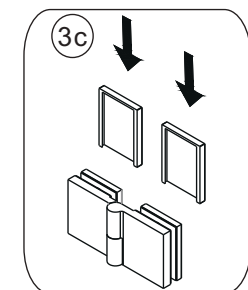

3c

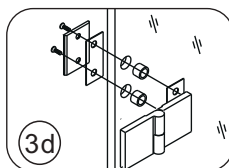
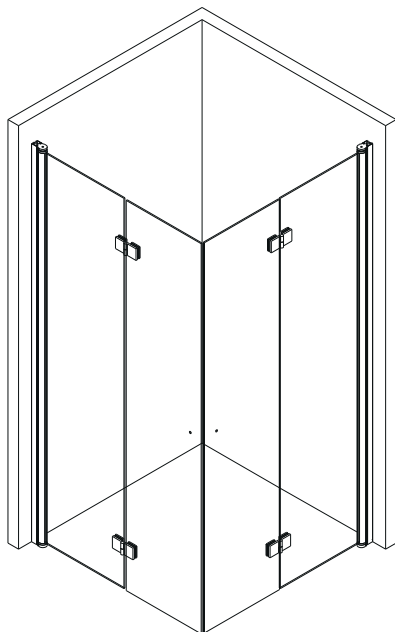

3d

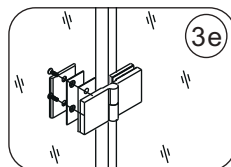

3e

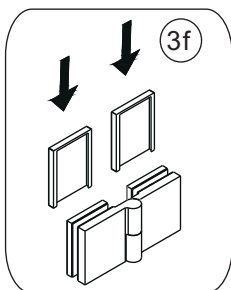

3f

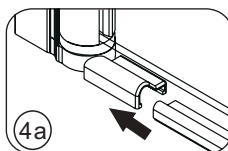
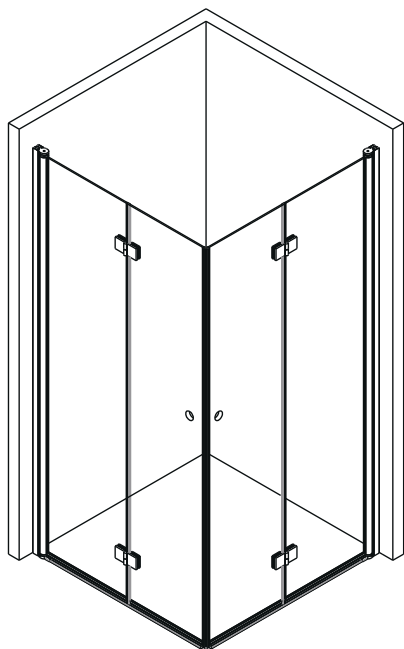

4a

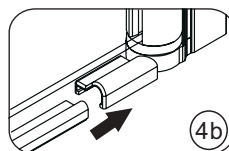

4b

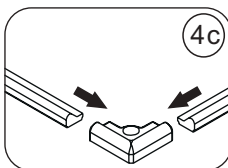

4c

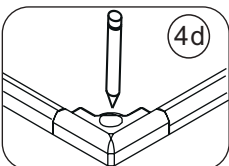

4d

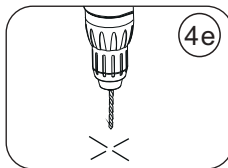

4e

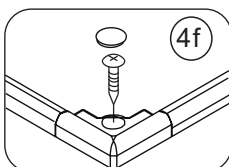

4f

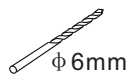

ϕ 6mm



ϕ 6*30



ST4*18



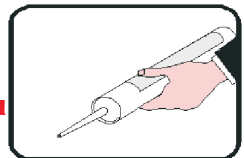
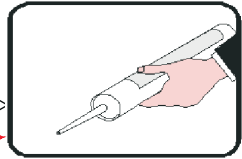
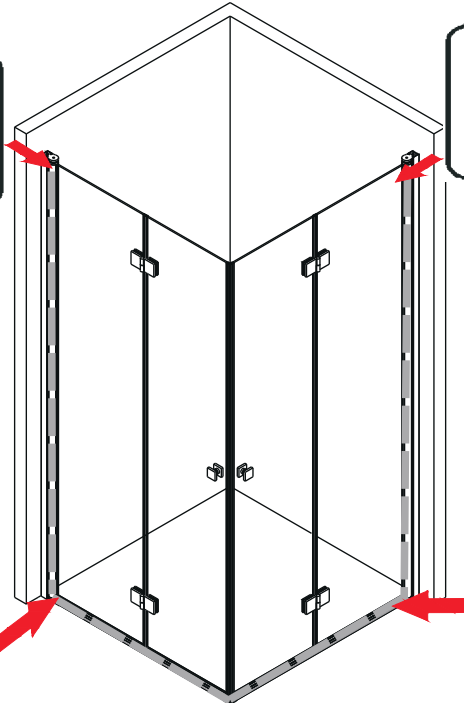
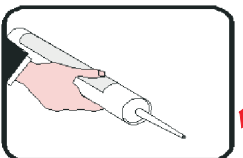
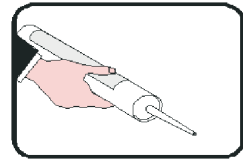
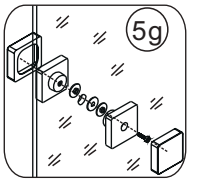
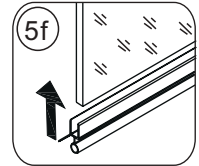
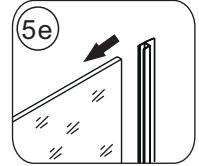
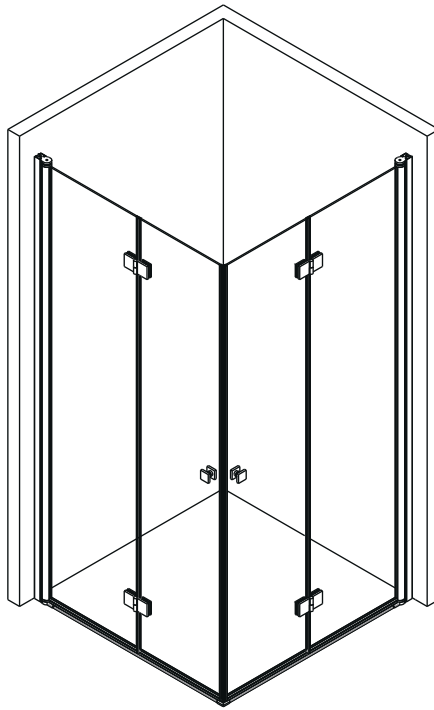
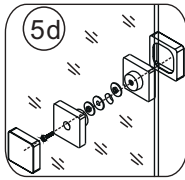
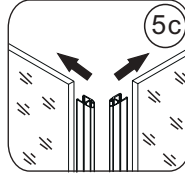
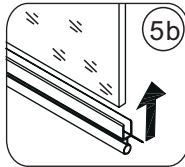
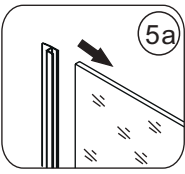

Cleaning & Maintenance

- Clean the sundries once the drain be jamed.
- Normally, clean the shower enclosure by mop with mild detergent or soap.
- Don't clean the shower enclosure with irritant detergent, alcohol, gasoline or other chemical cleaner.
- Should there have any dirty stains on the shower enclosure, you may clean it with vinegar of low density, but you must clean it with water afterwards.