

Sliding door

Installation instructions

(For L100/L106/L120/L130/L140/L150/L160/L170-CR)

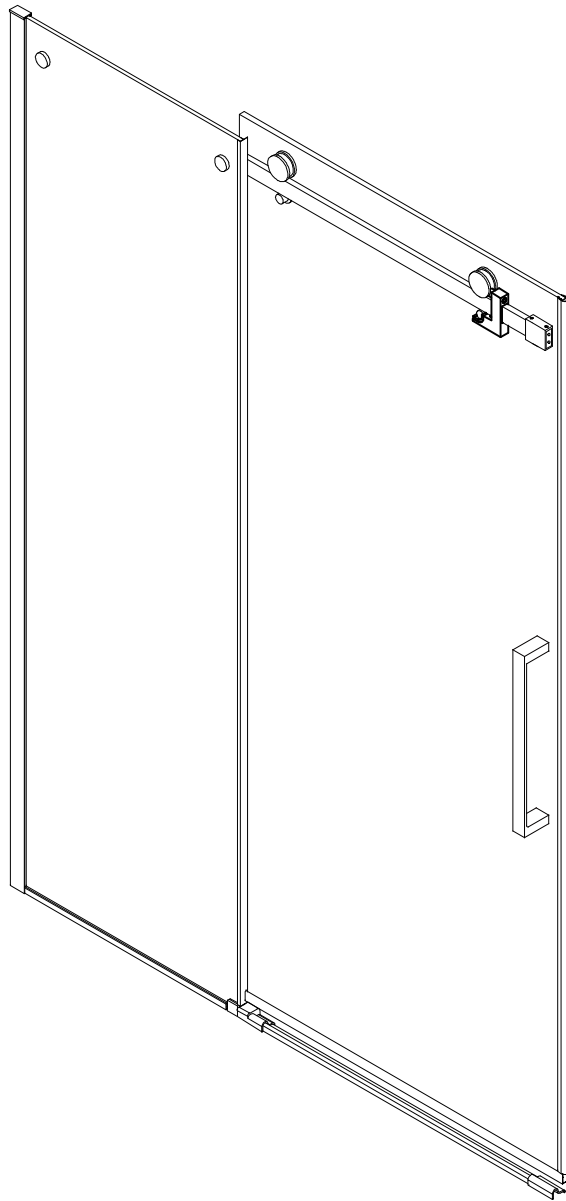

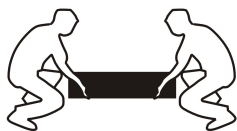
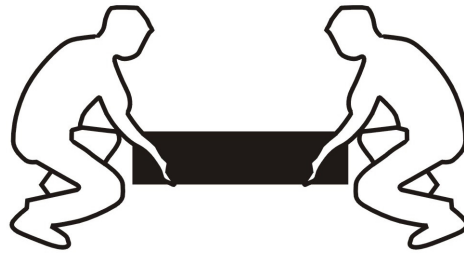
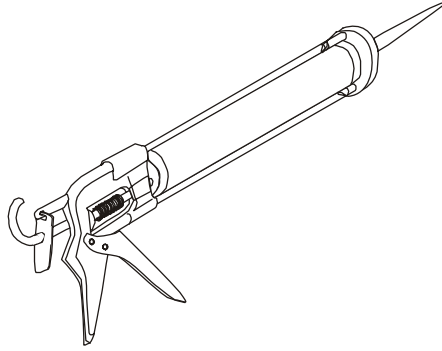

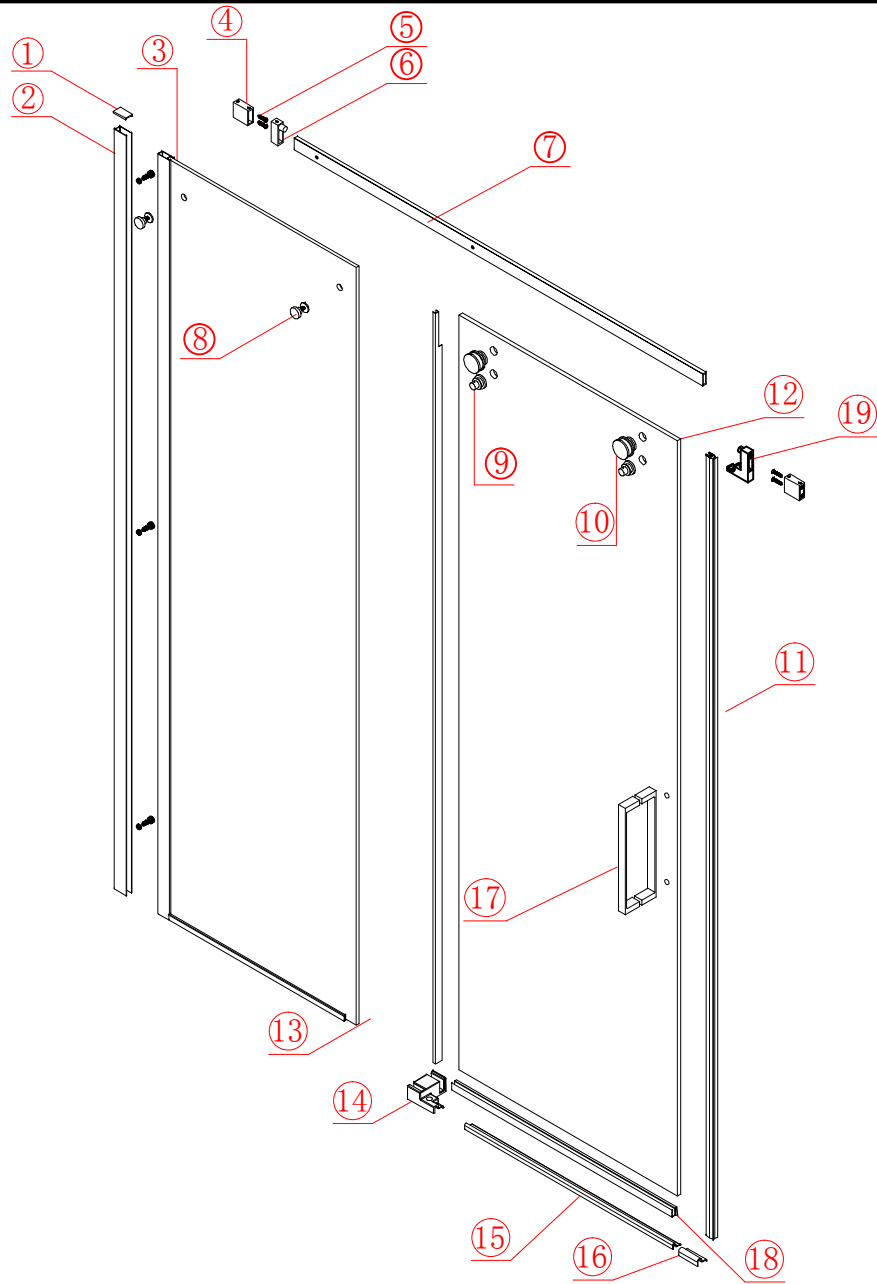

| | | | | | | |
|-------|-------|---------------|-------------------|-----------------|---------------|--------------|
| ① x 1 | ② x 1 | ③ x 1 | ④ x 2 | ⑤ x 4 ST5X35 | ⑥ x 1 | ⑦ x 1 |
| ⑧ x 2 | ⑨ x 2 | ⑩ x 2 | ⑪ x 1 | ⑫ x 1 | ⑬ x 1 | ⑭ x 2 L&R |
| ⑮ x 1 | ⑯ x 1 | ⑰ x 1 | ⑱ x 1 | ⑲ x 1 | x 3 ST5X30 | x 7 ∅8X30 |
| x 3 | x 3 | x 3 ST4X12 | x 3 BS-2.5/4/5 | x 1 | x 1 ST4X20 | |



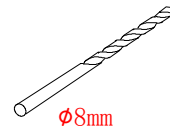
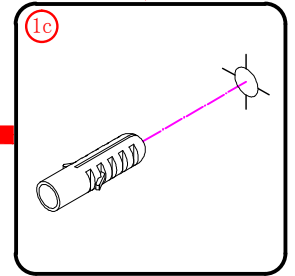
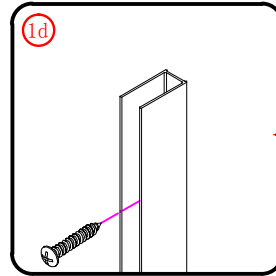
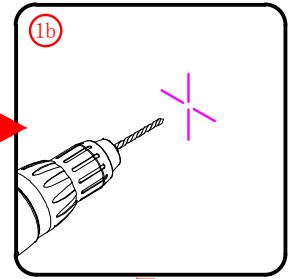
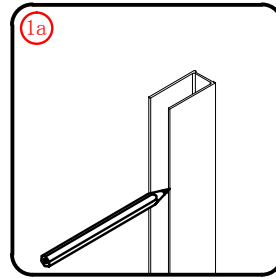
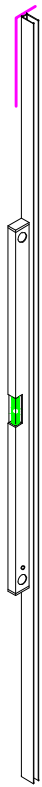

ø8mm

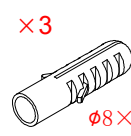

×3

ø8×30



×3

ST5×30

3

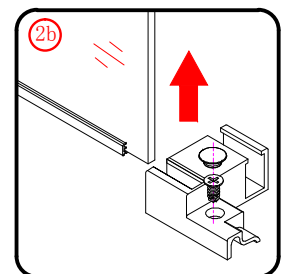
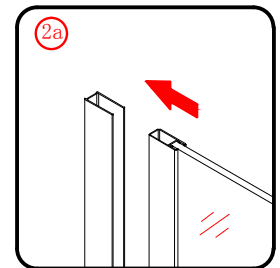
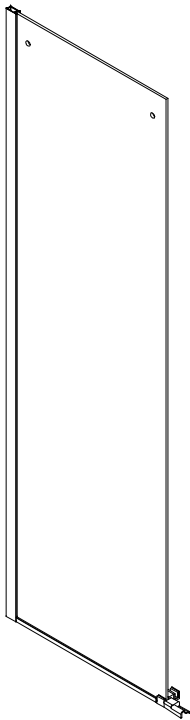

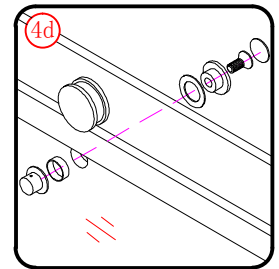
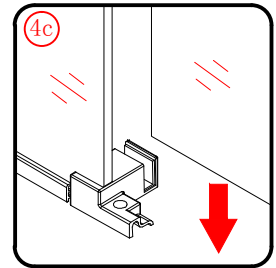
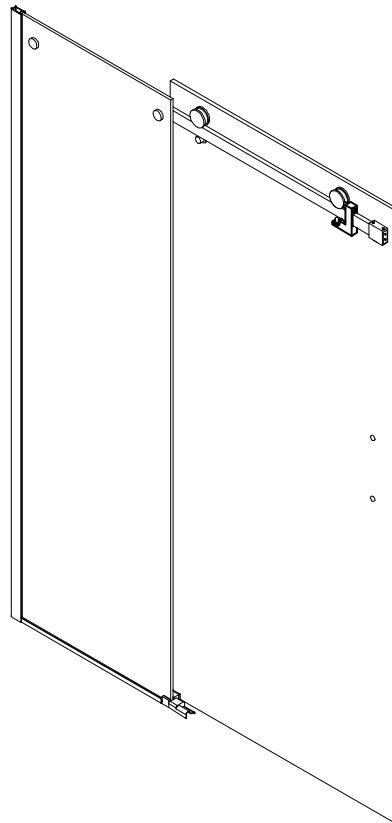
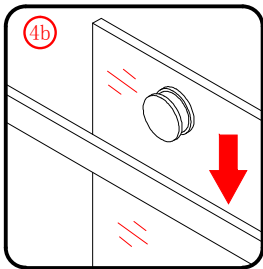
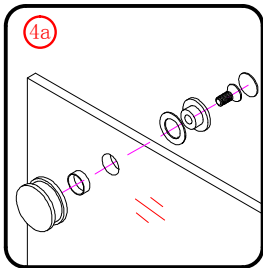
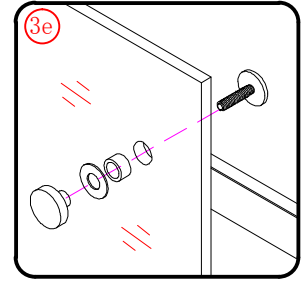
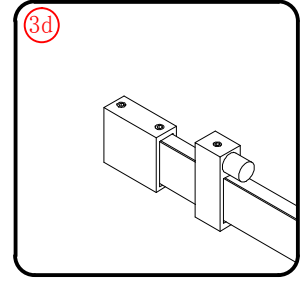
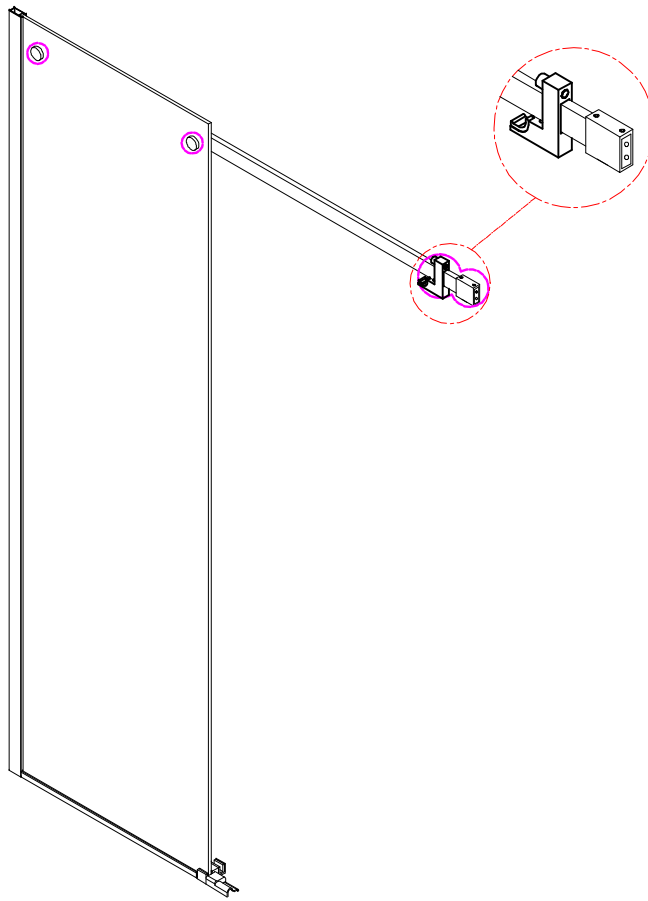
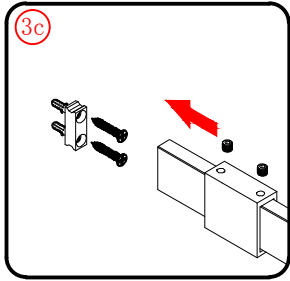
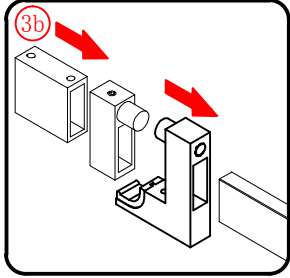
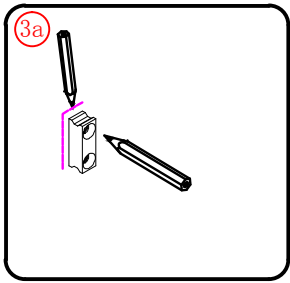

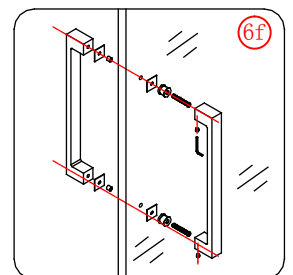
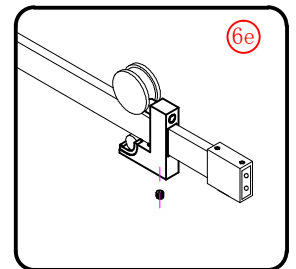
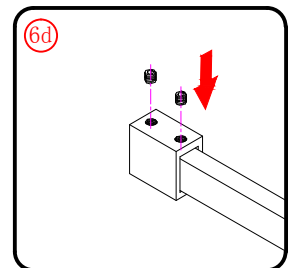
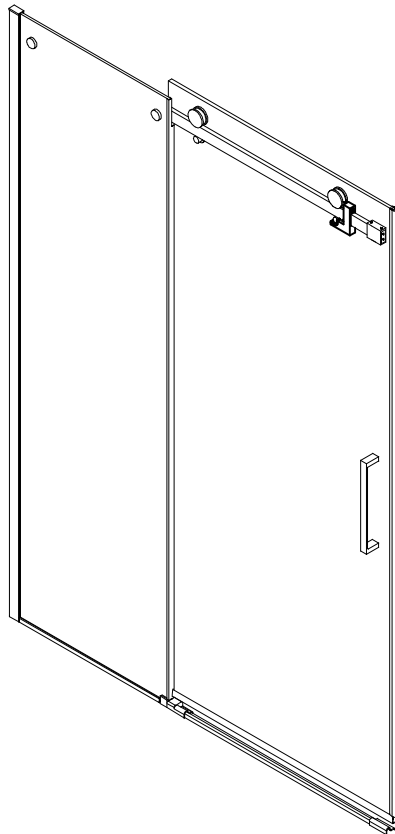
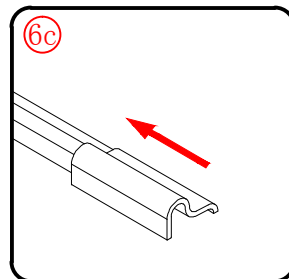
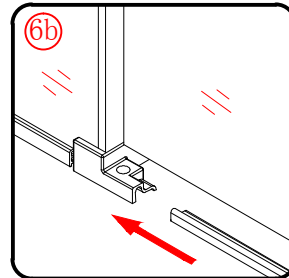
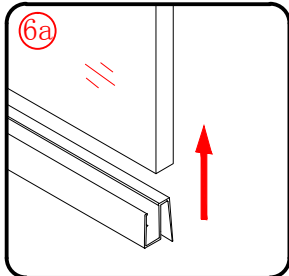
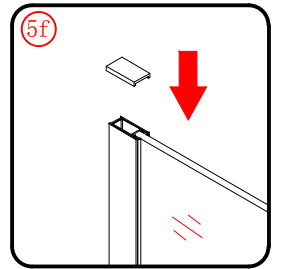
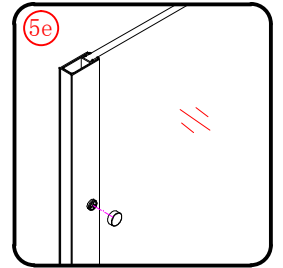
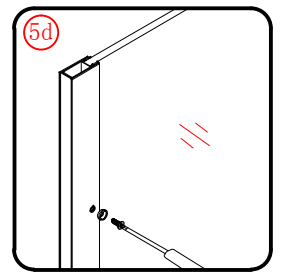
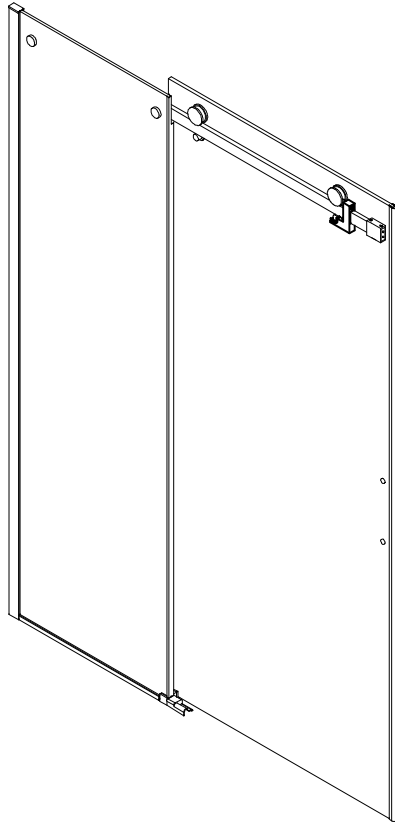
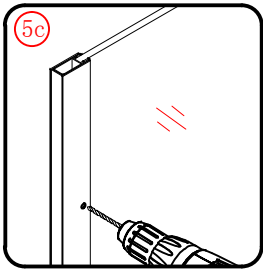
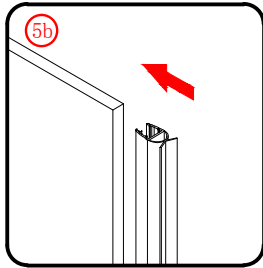
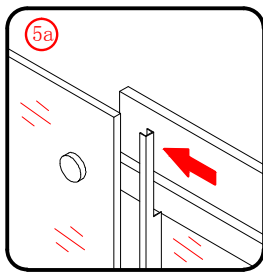

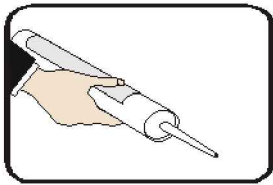
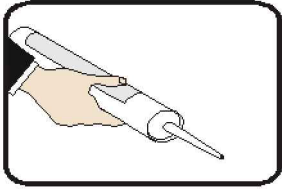
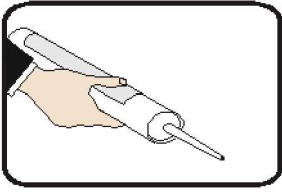

Coated
Glass

